



OWNER'S MANUAL & WARRANTY

XGUARD FOOD SHIELDS

LIGHTS & WARMERS

Thank you for choosing products from BSI. We appreciate your business and are available to assist you with all of your needs.

This manual has been designed to help you better understand your product and its proper usage.

If you have questions that go beyond this detailed manual please contact our Customer Service Department at 1.800.662.9595.

**Thank you,
The BSI Team**

TABLE OF CONTENTS

Contents	3	<i>Lights and Warmers</i>	
Introduction	3	Safety Precautions	18
Important Owner Information	3	Receiving and Inspecting the Equipment	18
Safety Precautions	4	Models	18
Receiving and Inspecting the Equipment	4	Maintenance and Fixtures	19
		Service and Ordering Parts	20
<i>XGuard Food Shields</i>		Wiring Diagrams	21-22
Models	5	Wiring Installations	23-24
Basic Components and Layout	6-7		
Glass Management	8-9	<i>Warranty</i>	25
XG3600 Assembly	10		
End Panels	11	<i>Notes</i>	26-27
XGuard Installation Options	12-14		
XGuard Accessories - ZSpace	15		

The BSI, LLC manual is an important part of your equipment. This document should be stored in a safe location, as it will be useful for the life of your product. It contains important safety information concerning the maintenance, operation and servicing of these products.

Failure to properly use this manual may result in serious injury. Do not operate this equipment unless you have read and understood the contents of this manual.

IMPORTANT OWNER INFORMATION

Record the model number(s) of your XGuard and serial number(s), of your warming units to use as a reference when contacting your local representative or the BSI headquarters in Colorado.

Model No.:	
Serial No.:	
Model No.:	
Serial No.:	
Date of Purchase:	
Other:	

BSI, LLC
 Business Hours: 8:00 a.m. to 4:30 p.m.
 Mountain Time

Telephone: (800) 662-9595; (303) 331-8777
 Fax: (303) 331-8444

Web Address: www.BSIdesigns.com



The XGuard Food Shield must be installed in accordance with the applicable installation code by a person familiar with the construction and operation of the product and the hazards involved.

RECEIVING AND INSPECTING THE EQUIPMENT

Even though most equipment is shipped crated, care should be taken during unloading so the equipment is not damaged while being moved into your facility.

1. Visually inspect the exterior of the package and skid or container. Any damage should be noted and reported to the delivering carrier immediately.
2. If damaged, open and inspect the contents with the carrier.
3. In the event that the exterior is not damaged, yet, upon opening, there is concealed damage to the equipment, notify the carrier. Notification should be made verbally as well as in written form.
4. Request an inspection by the shipping company of the damaged equipment. This should be done within 10 days from receipt of the equipment.
5. Be sure to check that there is no broken glass.
6. Be sure to check that all materials are received.
7. Freight carriers can supply the necessary damage forms upon request.
8. Retain all crating materials until an inspection has been made or waived.
9. All XGuard packages contain drawings for your installer.
10. All XGuard packages contain this Owner's Manual and Warranty.

All XGuard models are certified by NSF.



XGUARD MODELS

XGuard food shields are manufactured in many different configurations. While the components are all similar, your model's glass and posts may not be. Post will either be aluminum or stainless steel. The models shown below should be maintained in the same manner based on the instructions within this manual.

If you have questions regarding a XGuard or are interested in custom configurations please contact BSI, LLC at 1.800.662.8777.



XG3500



XG3500-2

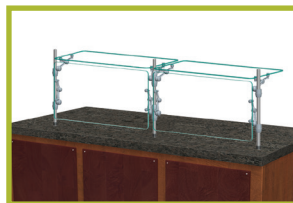

XG3500-3

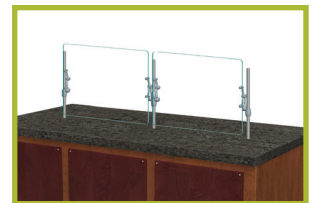

XG3500-4



XG3500-5



XG3500-6



XG3560



XG3600

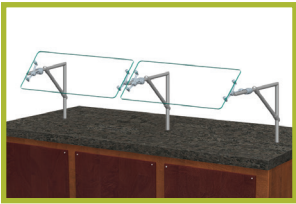

XG3900

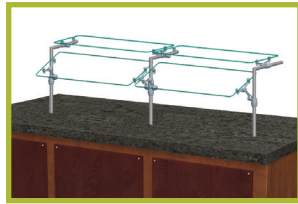

XG3915



XG3930



XG3930-2



XG3930-3

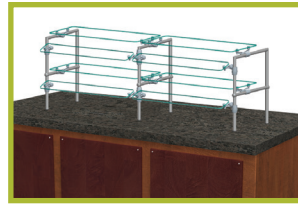

XG3930-5



XG3945



XG3945-3



XG3950



XG3950-2

BASIC COMPONENTS & LAYOUT

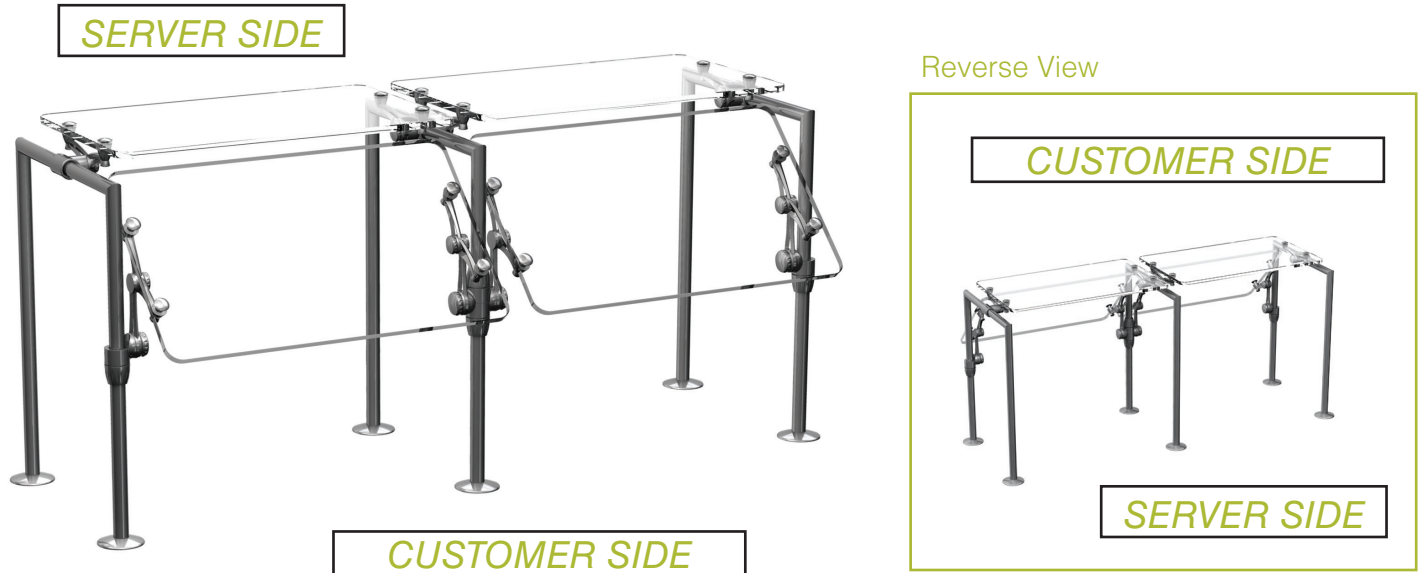

XGUARD BRACKETS

There is no left or right XGuard bracket. By rotating the Glass Clamp on the Full XGuard Bracket Assembly, the bracket can convert from left to right.

To complete a center bracket setup you will need two full bracket assemblies. One will be upside down (see picture).



Full XGuard Bracket Assembly



XGuard Center Bracket Assembly
(2 stacked brackets)



Top Shelf Bracket Assembly



Center Top Shelf Bracket Assembly



XGuard Bracket with Reducer Assembly
(used without extension arm)

XGUARD HALF BRACKET OPTIONS

In cases where your guard has a corner or bend half brackets or brackets without an extension arm may be used.

XGuard Half Bracket Assembly
(used for corners)



XGuard Half Bracket with Reducer Assembly
(used without extension arm, for corner sections)



SEE EXPLODED VIEWS AND PART NUMBERS ON PAGE 7.

XGUARD BRACKET ASSEMBLY AND PARTS



Full XGuard Bracket Assembly

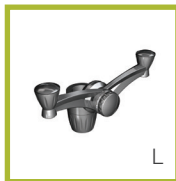

XGuard Bracket w/ Reducer Assembly (used without extension arm)



Top Shelf Bracket Assembly

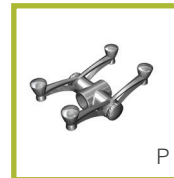

Center Top Shelf Bracket Assembly

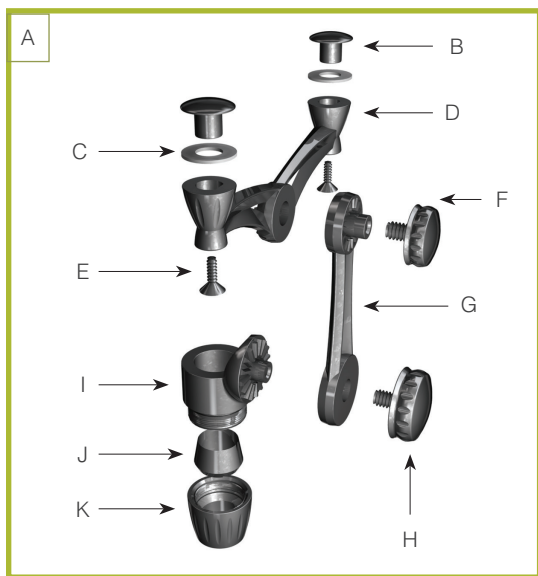

Location	Part #	Part Name
A	15924	Full XGuard Bracket Assembly
B	15931	Decorative Nut
C	484	Clear Mylar Spacer
D	15925	Glass Clamp
E		1/4-20 x 1-1/4" Machine Screw Flat Philips
F	15930	Small Knob
G	15926	Extension Arm
H	15929	Large Knob
I	15927	Collar Post Slide
J	14372	Slip Joint Washer
K	15928	Slide Collar Nut
L	15939	XGuard Bracket with Reducer Assembly
M	15934	Reducer
N	15937	Top Shelf Bracket Assembly
O	15932	Top Shelf Bracket
P	15938	Center Top Shelf Bracket Assembly
Q	15933	Top Shelf Bracket Center

* When ordering you **MUST** designate finish/color.

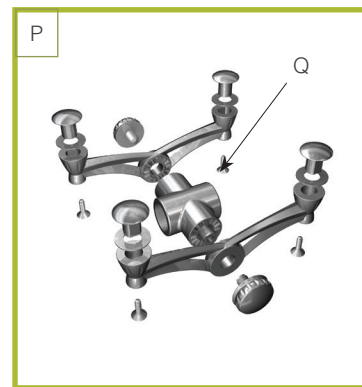
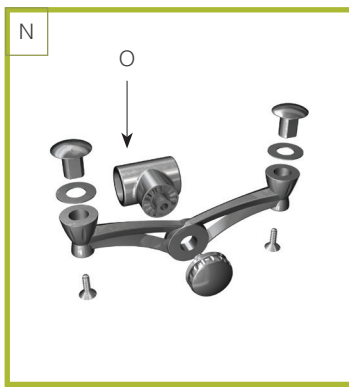

In the event that your XGuard product needs service and requires major repairs, contact your local installer for assistance. If you have questions about the products or need to replace minor parts you may contact BSI, LLC at 1.800.662.9595.

GLASS AND BRACKET POSITION

The XGuard bracket allows for three axis of movement. Bracket can move up and down the 1" post, pivot forward and backwards across the counter top and the angle of the glass can be tilted at 22-1/2° increments.



Range of Motion

XGUARD BRACKET ADJUSTMENT



Illustration #1: Bracket and glass in 'Home' position.

XGuard brackets allow you to adjust the food shield height, reach and angle of glass.

Referred to as the 'home' position, bracket and glass will be in vertical position.

With the assistance from a second person, take the following steps to adjust your XGuard.

If your food guard does not have a top shelf:

1. To raise or lower the bracket, loosen the Slide Collar Nut. Slide to new position and tighten. (See Illustration #2) Make sure your glass is level before proceeding.
2. To adjust glass forward or backward, loosen the Large Knob and then move bracket to desired location, The Extension Arm is marked with a raised triangle to assist with alignment. It corresponds with raised notches on the Collar Post Slide. (See Illustration #3)

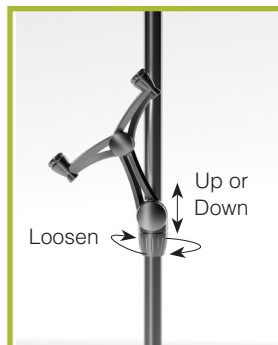

Illustration #2: Slide Collar Nut loosens to raise or lower XGuard Bracket..

3. To adjust the bracket angle, loosen the Small Knob and then adjust the angle of the bracket/glass to desired location. The Glass Clamp is marked with a raised triangle to assist with alignment. It corresponds with raised notches on the Extension Arm.
4. You may need to go back to a previous step to adjust for best suitable position.

If your food guard has a top shelf:

1. To adjust forward or backward position, loosen the Large Knob and then move bracket to desired location, The Extension Arm is marked with a raised triangle to assist with alignment. It corresponds with raised notches on the Collar Post Slide.
2. To adjust the bracket angle, loosen the Small Knob and then adjust the angle of the bracket/glass to desired location. The Glass Clamp is marked with a raised triangle to assist with alignment. It corresponds with raised notches on the Extension Arm.
3. To raise or lower the bracket, loosen the Slide Collar Nut from the Slide Collar Post. Slide to new position and tighten.
4. You may need to go back to a previous step to adjust for best suitable position.

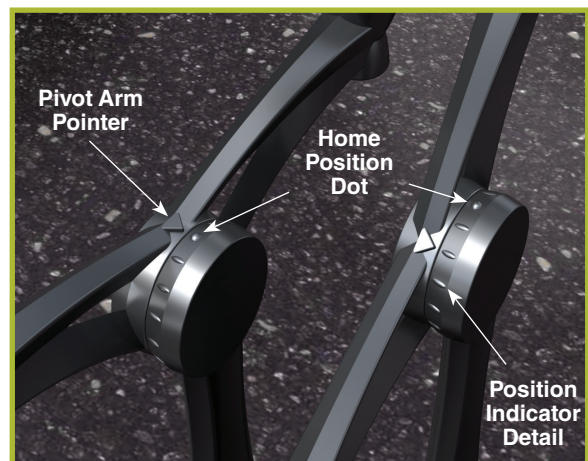

Illustration #3: Detailed View of Bracket Indicators

CLEANING INSTRUCTIONS

Cleaning your new XGuard product is key to its long life.

BSI recommends the following for keeping your product clean:

- Wipe the surface with a clean, damp cloth to remove fingerprints, dust, etc.
- Spray with a light coating of glass cleaner to remove grease or other dirt. Use a non-ammonia cleaner.
- Do not polish XGuard with any metal polish. Your XGuard has a durable finish and will maintain its finish for years if well maintained. (Polishing the finish with a polishing agent of any kind will destroy the coating.)
- Do not scrub the surface with any abrasive substance such as steel wool, pot scrubbers, Ajax cleanser, Comet or similar products, as it will remove the protective coating.
- If unit is fitted with a stealth warmer, don't clean the glass or housing fixtures when warmer is hot.

Cleaning when over head warmer is hot can cause staining or damage to food warmer finish.



GLASS LIMITATIONS

XGuard food shield systems that are equipped with a shelf are not intended to withstand heavy weights. Glass shelves can certainly hold small display items.

Do not exceed **75lbs.** total weight of all display items across a three-foot panel of 3/8" thick glass.

TESTING PARAMETERS

Food Shield:	XG3500 (glass panel positioned at 90° to post)
Posts & Brackets:	Brushed Aluminum
Glass:	36" x 14" (3/8" thick)
Mounting:	Above Counter
Time:	24 hours

XGUARD XG3600 ASSEMBLY

XG3600 Assembly Instructions

1. From the underside, use the provided screws to attach the stabilizer to each foot. There are two alternate locations for stabilizer placement.
2. Right side up, screw in the two posts. There are two alternate locations for post placement.
3. In the non-used post holes screw in the provided foot plugs.
4. Affix the glass panel to the left and right bracket assemblies.
5. Slide the brackets onto the left and right post. At level height tighten bracket for secure hold.
6. With the brackets parallel to the counter, screw the glass panel to the brackets.
7. Adjust glass angle, forward/backward position and height as needed.

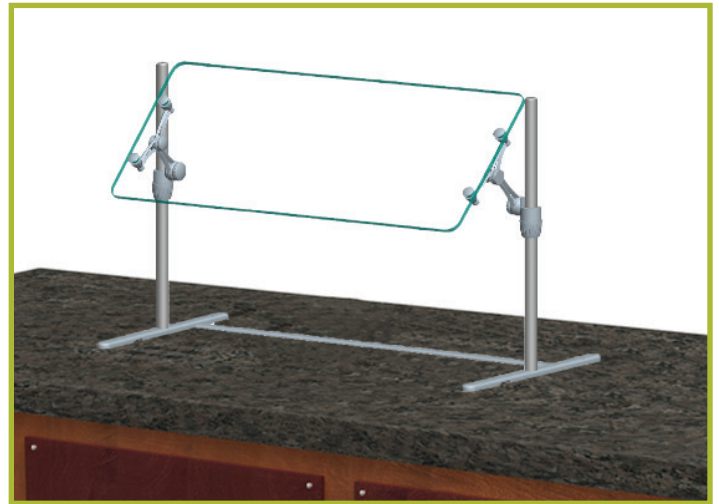

Location	Part #	Part Name
R		Market Stabilizer Screw
S	415	Market Stabelizer
T	416	Market Style Foot
U	348	Post
V	361	Foot Plug
W		Glass Panel
X	15924	Left/Right Bracket Assembly

* When ordering you **MUST** designate finish/color.

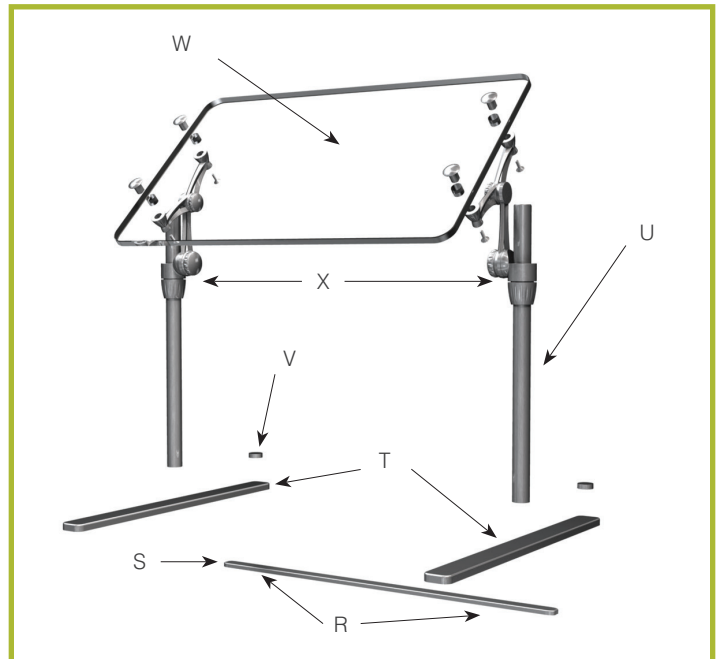

NSF REQUIRED END PANELS FOR XGUARD

To meet NSF guidelines, end panels are included on all BSI quotations unless specifically excluded.

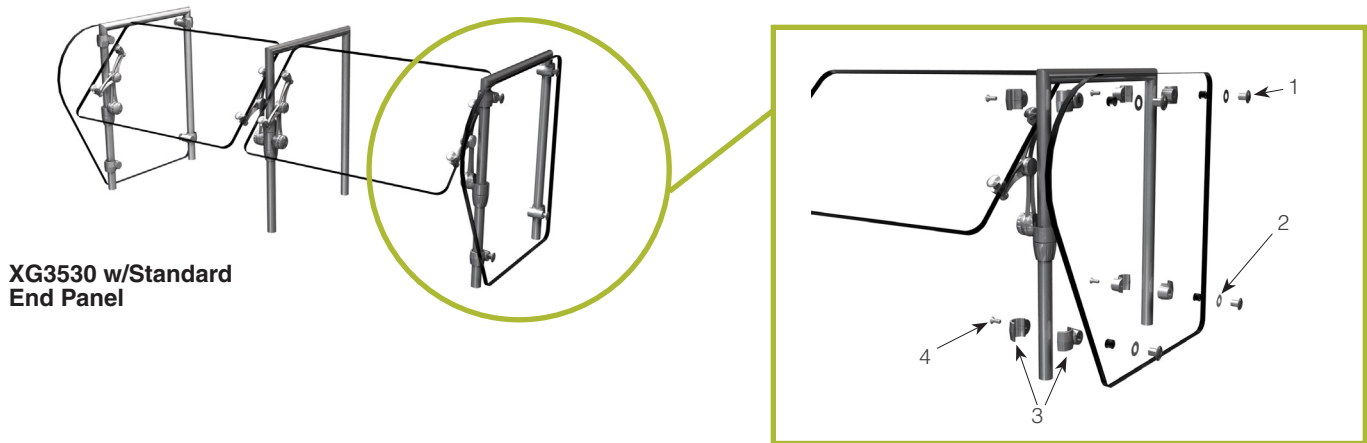

XG3530 w/Standard End Panel

Location	Part #	Part Name
1	15931	Decorative Nut
2	484	Clear Mylar Spacer
3	15756	End Panel Bracket Assembly
4		1/4-20 x 1-1/4" Machine Screw Flat Philips

NSF End Panel Requirement Exemption

NSF/ANSI Standard 2 - 2018

5.36.1.6.2 A food shield intended to be installed a maximum of 3 in (76 mm) from a building wall perpendicular to the food shield is exempt from the requirements of 5.36.1.6.1 provided that the height of the building wall is not lower than the overall height of the food shield. The manufacturer's specification sheet, brochure, installation instructions and/or shop drawings shall include these building wall and proximity requirements.

ABOVE-COUNTER INSTALLATION FOR 1" XGUARD POSTS

For Stainless Steel Counter
SS1: EZ Mount 2" x 8" Flange

Location	Part #	Part Name
10	348	1" Threaded Post
11	485	EZ Mount Center Flange Cover
12		10-32 x 1" S/S Screw Flat Phillips
13	470	EZ Mount Base Flange Centered
14		Rivet Nut
15	473	EZ Mount Flange Plate Centered
16	464	Heavy-Duty Flange Cover
17		#12 x 2 A Tapping Screw Flap Phillips
18	471	Heavy-Duty Flange
19	465	Narrow Flange Cover
20	378	Narrow Flange
21	442	Grommet

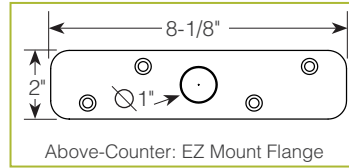
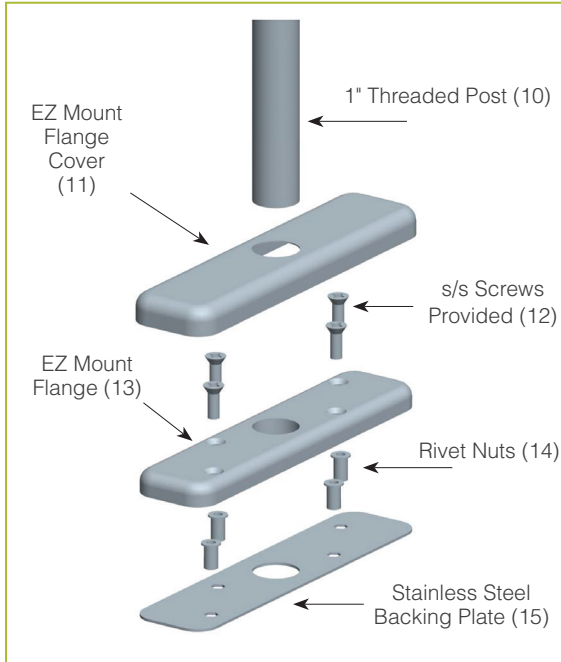

For Millwork Counter
MW1: Heavy Duty Flange

For Millwork Counter
MW2: Narrow Flange

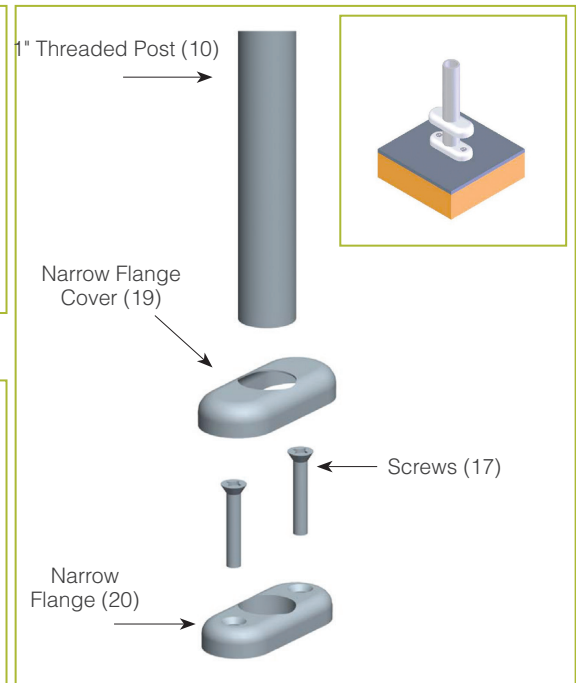
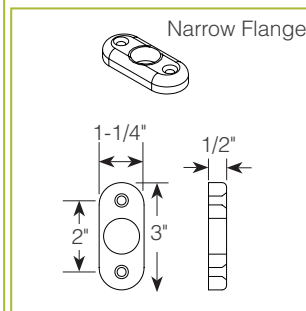
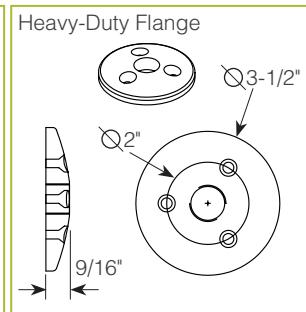
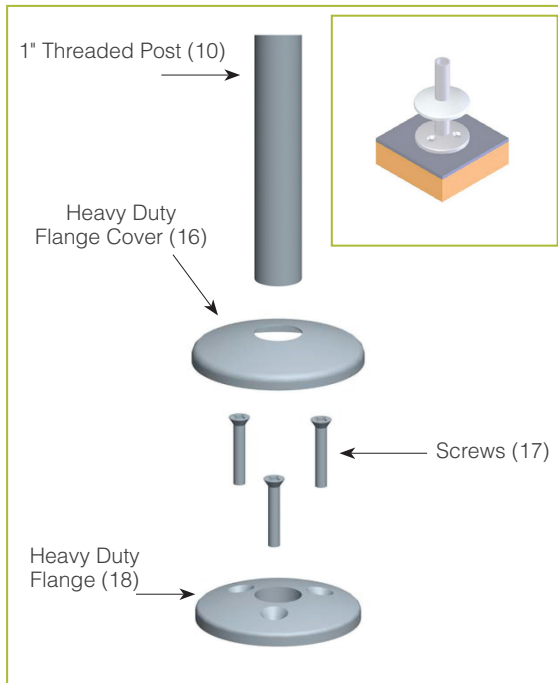

UNDER-COUNTER INSTALLATION FOR 1" XGUARD POSTS

For Stainless Steel Counter
 (requires under-counter reinforcement and access)
SSU3: Heavy Duty Flange (-H) or Narrow Flange (-N)

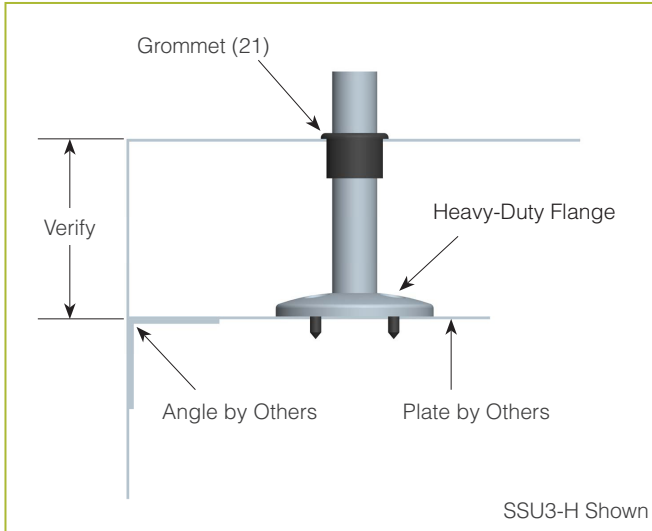

For Stainless Steel Counter
 (requires under-counter reinforcement and access)
SSU5: Heavy Duty Flange (-H) or Narrow Flange (-N)

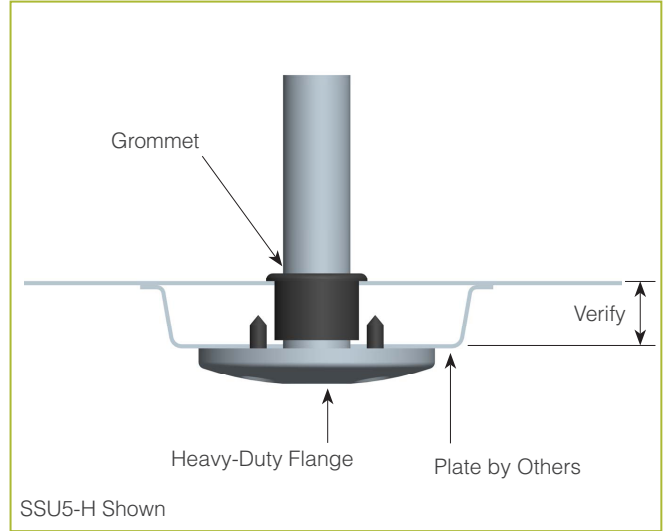

Verify Counter Thickness or Under-Counter Installation Depth in Inches

For Millwork Counter
MWU3: Narrow Flange

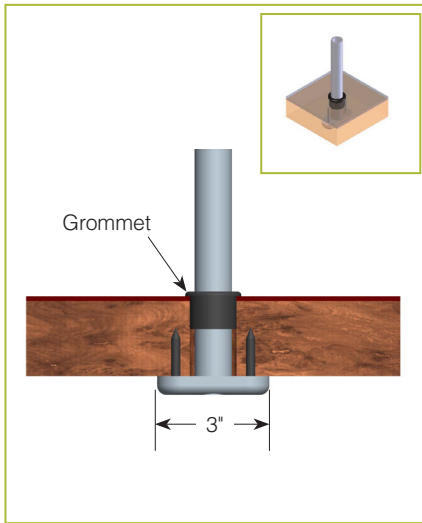

For Millwork Counter
MWU4: Compression Installation
 (not recommended for solid surfaces)

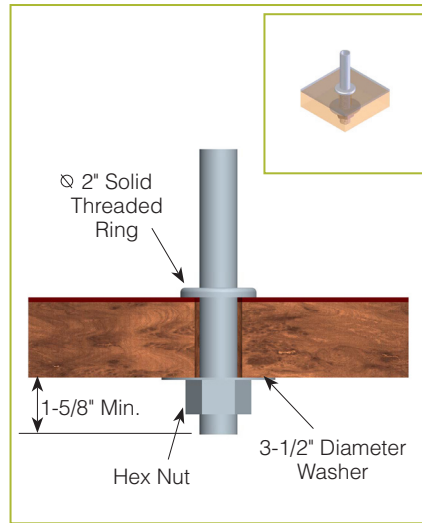

For Millwork Counter
MWU5: Heavy Duty Flange

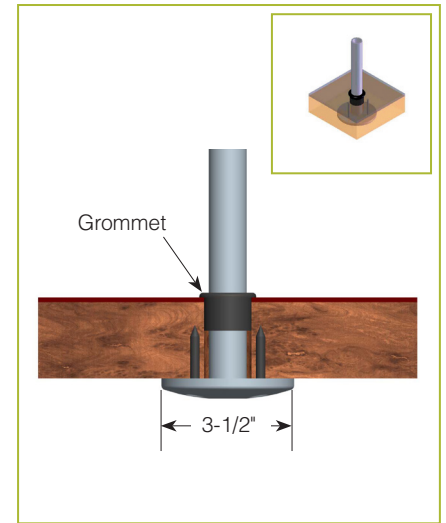

Verify Counter Thickness or Under-Counter Installation Depth in Inches

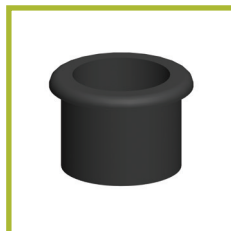

For below-counter installation a 1-1/4" diameter grommet is required. (21)

➤ ABOVE-COUNTER INSTALLATION FOR 1-1/2" XGUARD POSTS

For Millwork Counter
Surface Installation 720A/726A:
Steel Post and Flange w/Flange Cover

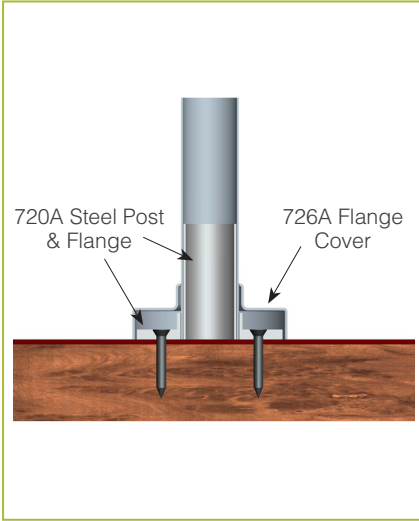

For Millwork Counter
Surface Installation 725A:
Cut Flange

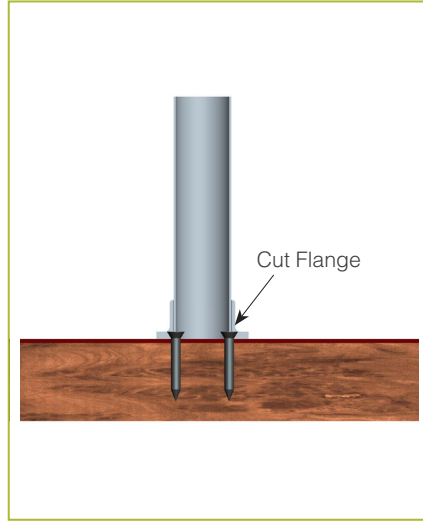

For Millwork Counter
Concealed Fastener
(not for cantilever units)

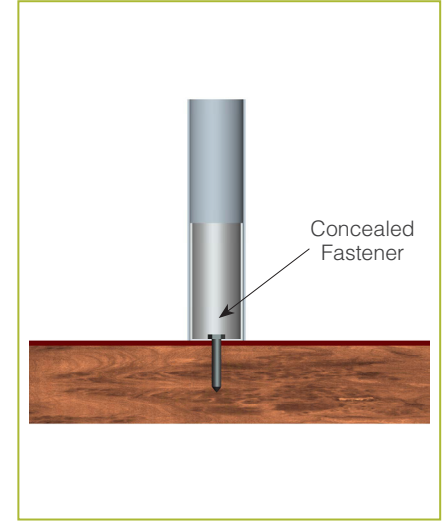

➤ UNDER-COUNTER INSTALLATION FOR 1-1/2" XGUARD POSTS (requires under-counter reinforcement and access)

Under-Counter Installation 720A/726A:
Steel Post and Flange w/Flange Cover

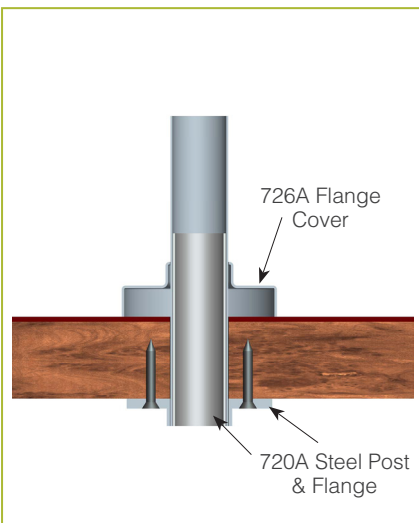

Under-Counter Installation 720A:
Steel Post and Flange w/out Flange Cover

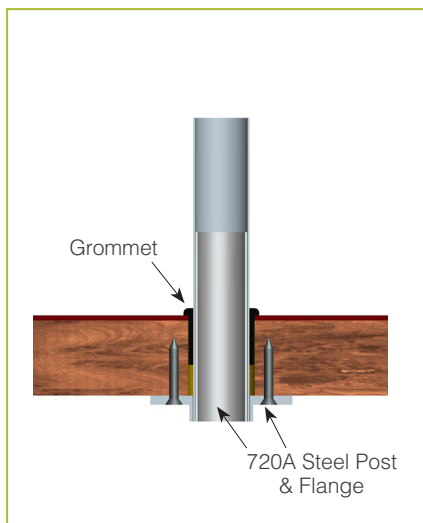

Under-Counter Installation 725A:
Narrow Custom Flange

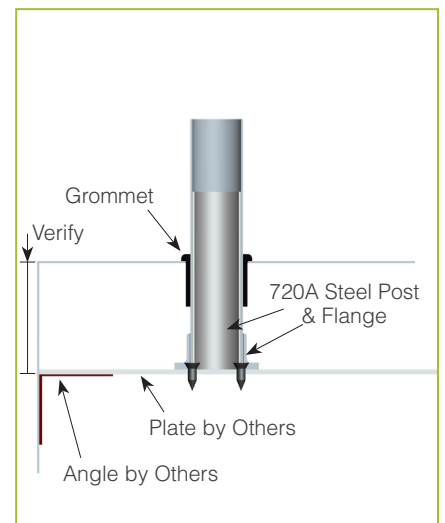

➤ FLANGE AND FLANGE COVER DIMENSIONS

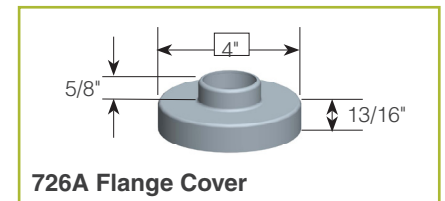
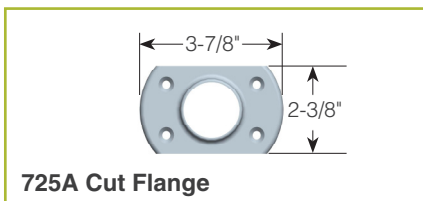
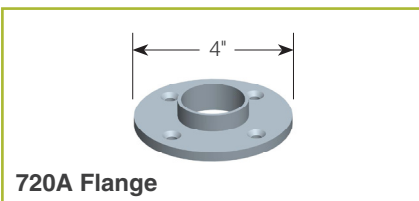

Once installed, XGuard offers your servery additional merchandising solutions. BSI, LLC offers ZSpace modular merchandising products. ZSpace allows you to take advantage of every inch of your counters and the space above them. ZSpace offers innovative products ranging from trivets, trays and POP displays that attach to your existing food shields and offer sales/merchandising opportunities like never before.

ZSPACE COMPONENTS

Just install the incredible EZ-Clamp anywhere on your XGuard food shield and add up to three Flexi-Rings. The rings can hold bowls, trivets, vases or any other container to create innovative merchandising displays.

ESSENTIALS



EZ-Clamp



Flexi-Ring

DISPLAY OPTIONS



Aluminum Tray



Acrylic Trivet

GET NOTICED



Post-Mounted Sign



Small Crescent Sign

ZSPACE KITS

BSI offers pre-chosen ZSpace Kits with suggested themes to help you save time. Nearly every combination can be created by you or with our help.



Large Salad Bar Display



Three-Tier Display

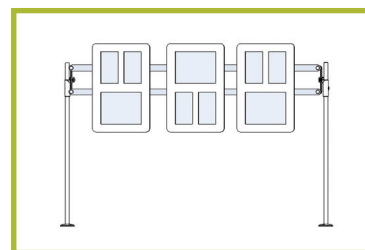

Menu Frames

**Not all components shown.
For more information about our line of
ZSpace Components and ZSpace Kits
please contact us at 1.800.662.9595 or
visit us at www.BSIdesigns.com.**



OWNER'S MANUAL & WARRANTY

LIGHTS & WARMERS

XGuard food shield systems can be built with lights, warmers or a combination of the two. Proper maintenance for these products is very important for safety. The following pages will detail the proper methods of keeping your product clean, how and where to exchange parts, and include diagrams for proper wiring.

RECEIVING AND INSPECTING THE EQUIPMENT

Even though most equipment is shipped crated, care should be taken during unloading so the equipment is not damaged while being moved into your facility.

1. Visually inspect the exterior of the package and skid or container. Any damage should be noted and reported to the delivering carrier immediately.
2. If damaged, open and inspect the contents with the carrier.
3. In the event that the exterior is not damaged, yet, upon opening, there is concealed damage to the equipment, notify the carrier. Notification should be made verbally as well as in written form.
4. Request an inspection by the shipping company of the damaged equipment. This should be done within 10 days from receipt of the equipment.
5. Be sure to check that there is no broken glass.
6. Be sure to check that all materials are received.
7. Freight carriers can supply the necessary damage forms upon request.
8. Retain all crating materials until an inspection has been made or waived.
9. All packages contain drawings for your installer.
10. All Light and Warmer packages contain this Owner's Manual and Warranty.



ALL LIGHTS, WARMERS AND COMBO UNITS ARE SHIPPED USING ZIP TIES TO SECURE UNITS DURING TRANSIT. AFTER INSTALLATION, CAREFULLY REMOVE ALL ZIP TIES.



This product must be installed in accordance with the applicable installation code by a person familiar with the construction and operation of the product and the hazards involved.

All Light and Warmer models are certified by NSF.



MODELS



Slimline Light Model 2580

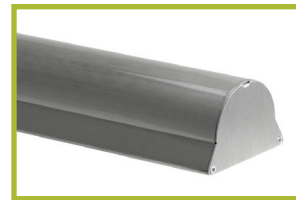

Stealth Warmer Model 490

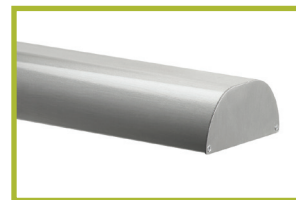

Stealth Warmer & Light Combo Model 605

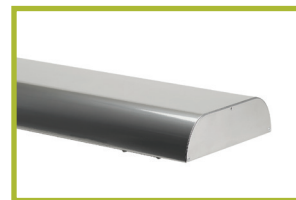

Stealth Double Warmer & Light Combo Model 500

CLEANING INSTRUCTIONS

Once your XGuard has been properly installed and you have removed all zip ties from transportation, it will be important to keep your light, warmer or combo unit clean to prolong the life of the product.

BSI recommends the following for keeping your product clean:

- Be sure to turn the power on your light or warmer off before cleaning. Only clean when stealth warmer is cool. **Cleaning when the warmer is hot can cause staining or damage to food warmer finish.**
- Wipe the surface with a clean, damp cloth to remove fingerprints, dust, etc.
- Spray with a light coating of glass cleaner to remove grease or other dirt. Use a non-ammonia cleaner.
- Be sure not to spray any cleaning product directly into the bulbs, fixtures or heating elements.

IDENTIFYING YOUR PRODUCT

Each BSI light, warmer or combo unit contains an Identification Sticker. This sticker provides the customer with the following information:

- Serial Number
- Model Number
- Manufacture Date
- Electrical Information

Sample Stealth Warmer Sticker with everything you need to know about your unit.



CHANGING THE FLUORESCENT BULB

When a fluorescent bulb burns out and needs to be replaced you will need to do the following:

- Turn off power to all lights and warmers.
- Carefully push the white lever to the opposite side, rotating the bulb 90°.
- Rotating the lever will unlock the bulb. The pins will now be visible through the open slots at each end. Caution: At this position, bulbs are free to fall down through open slots.
- If the bulb does not easily slide out from the holders, tap lightly on housing first, then carefully use needle-nose pliers to grab the bulb, evenly pulling it down and out.
- Once the defective bulb is removed, remove the white lever end cap from the bulb prongs and proceed to place it on the new bulb prongs.
- With the new bulb in hand, evenly push the pins on both ends up and into the open slots of the lamp holders.
- Carefully push the white lever to the opposite side, rotating the bulb 90° and locking it into place. Pins will no longer be visible.

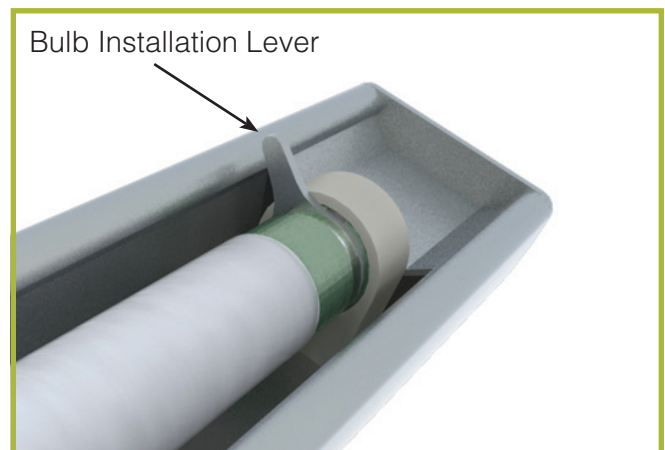

**Do not use high-output bulbs.
Use coated, shatter-proof bulbs.**

❖ CHANGING THE LED BULB

When a LED bulb burns out and needs to be replaced you will need to do the following:

- Turn off power to all lights and warmers.
- Carefully unscrew the end plate and slide out the entire LED light.
- If multiple lights are connected to each other carefully disconnect Serial Connector or Power Connector.
- Once dead light is removed, replace with new LED light. Carefully reconnect the connector and slide in the light bar.
- Replace end cover and the two screws.

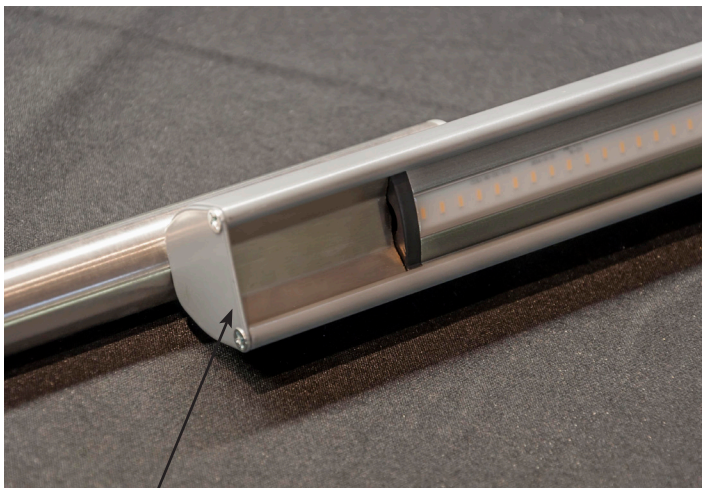

End Plate

❖ PARTS & SERVICE

In the event that your Lights or Warmers need service and require major repairs, contact your local installer for assistance.

If you have questions about the products or need to replace minor parts you may contact BSI, LLC at 1.800.662.9595.

❖ ORDERING NEW FLUORESCENT BULBS

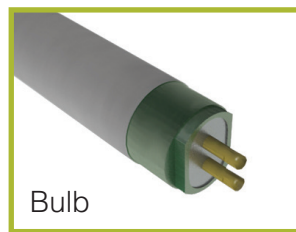

Part #	Description (All bulbs 4100K)
508-8-C	F8-T5/CW - 12" Long
508-14-C	F14-T5/CW - 22" Long
508-21-C	F21-T5/CW - 34" Long
508-28-C	F28-T5/CW - 46" Long
508-35-C	F35-T5/CW - 58" Long

Part #	Description
512	Bulb Installation Lever

❖ ORDERING NEW LED LIGHTS

Part #	Description
16289	Kelly LED:_12"_LED_Light_Bar
16290	Kelly LED:_18"_LED_Light_Bar
16292	Kelly LED:_36"_LED_Light_Bar
16505	Kelly LED:_48"_LED_Light_Bar
16293	Kelly LED:_10'_Power_Cord_w/o_Plug
16294	Kelly LED:_Serial_Connector
16295	Kelly LED:_6" Power_Connector

REPLACING THE TUBULAR HEATING ELEMENTS

On all three Stealth Warmer units the tubular heating element can burn out, similar to a light bulb.

Replacing the tubular heating element should be completed by a Professional Service Technician. If you have additional questions please contact BSI at 1.800.662.9595.

ORDERING NEW HEATING ELEMENTS

Part #	Description
492-18-BK	Element:_18"_120V_Heater_350W
492-24-BK	Element:_24"_120V_Heater_500W
492-30-BK	Element:_30"_120V_Heater_660W
492-36-BK	Element:_36"_120V_Heater_800W
492-42-BK	Element:_42"_120V_Heater_950W
492-48-BK	Element:_48"_120V_Heater_1100W
492-54-BK	Element:_54"_120V_Heater_1250W
492-60-BK	Element:_60"_120V_Heater_1400W
492-66-BK	Element:_66"_120V_Heater_1560W

Part #	Description
496-24-BK	Element:_24"_208V_Heater_500W
496-30-BK	Element:_30"_208V_Heater_660W
496-36-BK	Element:_36"_208V_Heater_800W
496-42-BK	Element:_42"_208V_Heater_950W
496-48-BK	Element:_48"_208V_Heater_1100W
496-54-BK	Element:_54"_208V_Heater_1250W
496-60-BK	Element:_60"_208V_Heater_1400W
496-66-BK	Element:_66"_208V_Heater_1560W

240V Heat Elements are a Special Order Item. Contact BSI at 1.800.662.9595 to place an order.

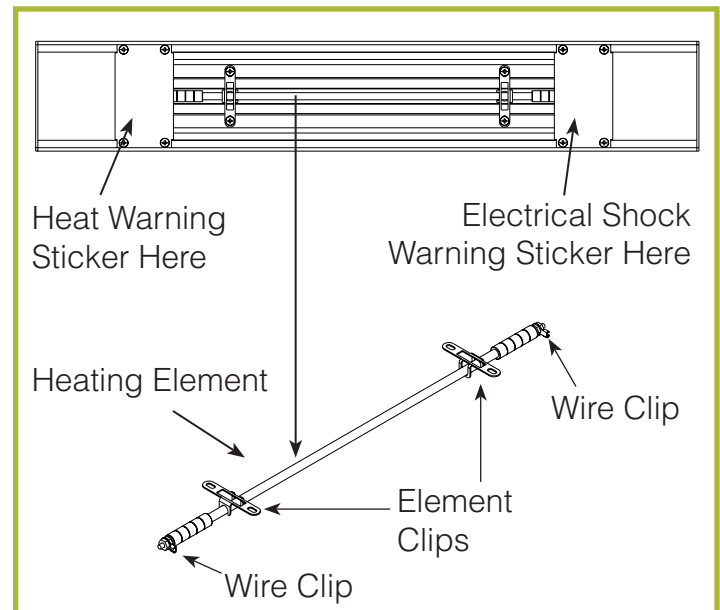

WIRING INSTALLATIONS

Fluorescent Light/Stealth™ Warmer Combo

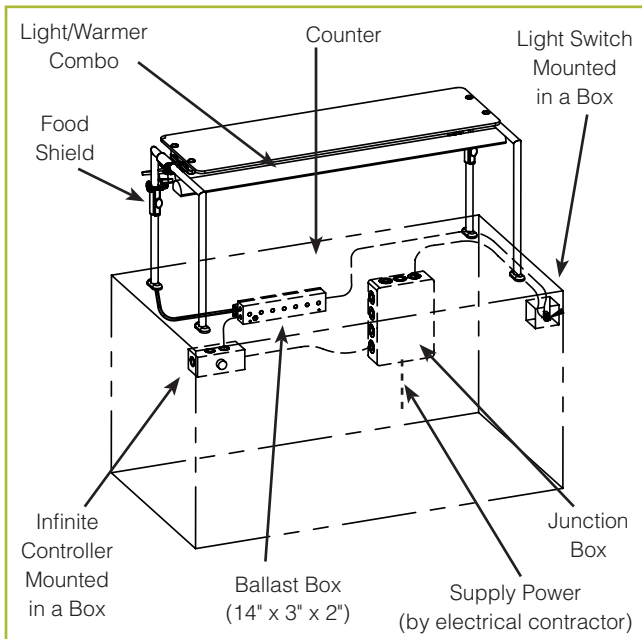

LED Light/Stealth™ Warmer Combo

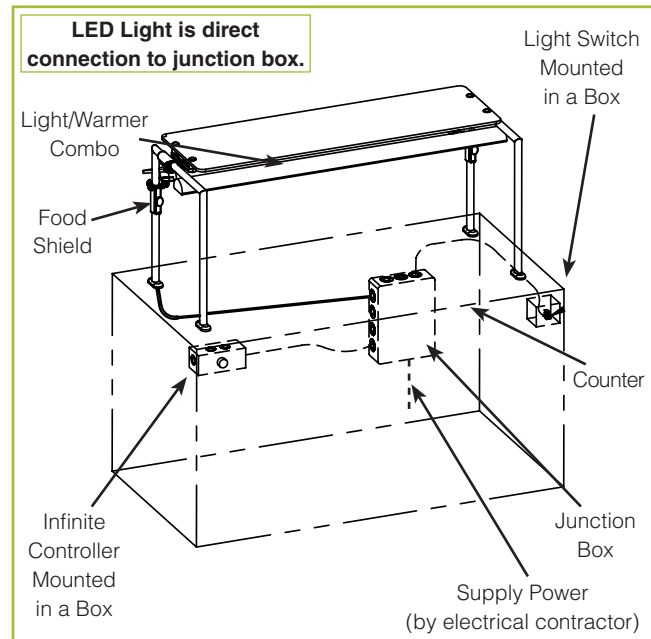

Stealth™ Warmer Combo Heat Light Heat (Fluorescent)

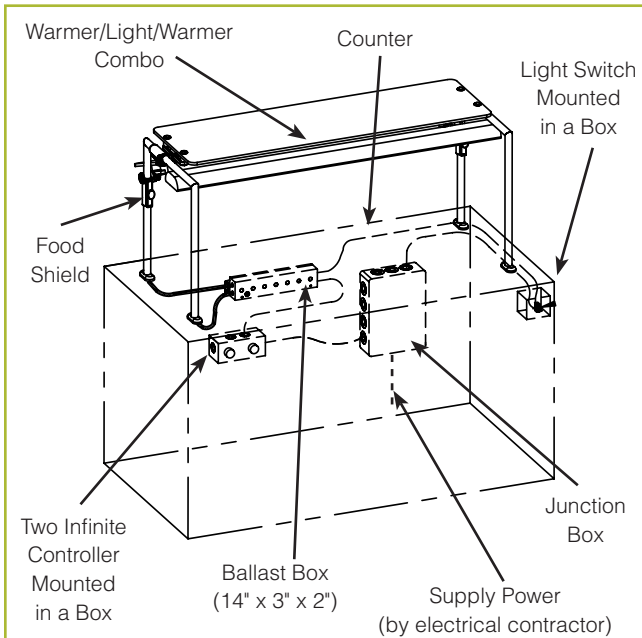

Stealth™ Warmer Combo Heat Light Heat (LED)

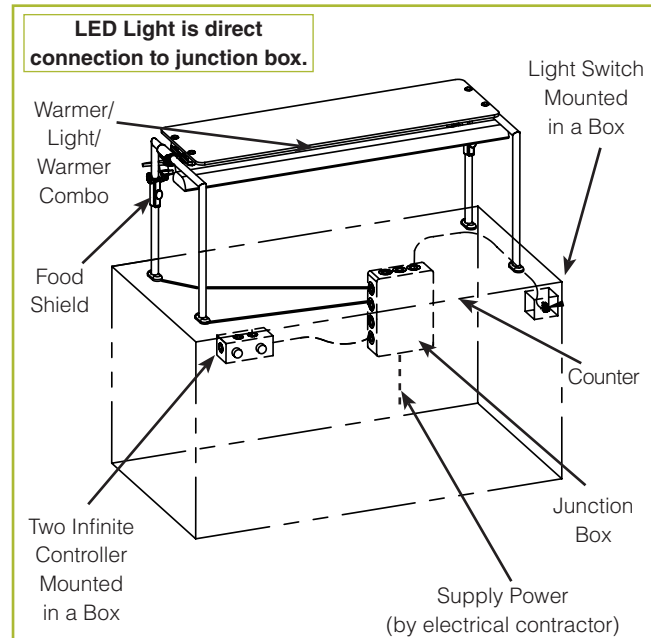

Typical Food Shield Light and Warmer Installations

- All wiring should be performed by a certified technician.
- Wires are routed through wire chase/support legs per approved shop drawings.
- Mount the ballast box, infinite controllers near the wire chase/support leg.
- The ballast box, infinite controllers, light switch and 6 feet of conduit/wiring exiting support legs are all provided with all models of BSI, LLC Food Shields. All other components are provided by others.

WIRING INSTALLATIONS

Fluorescent Lights

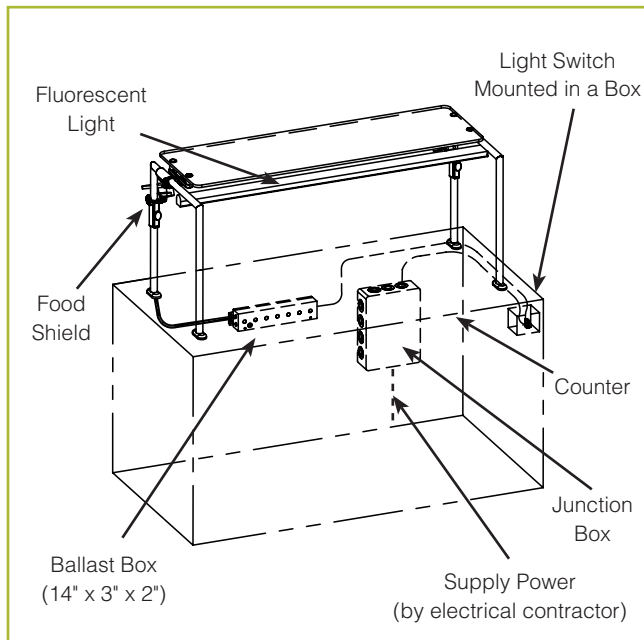

LED Lights

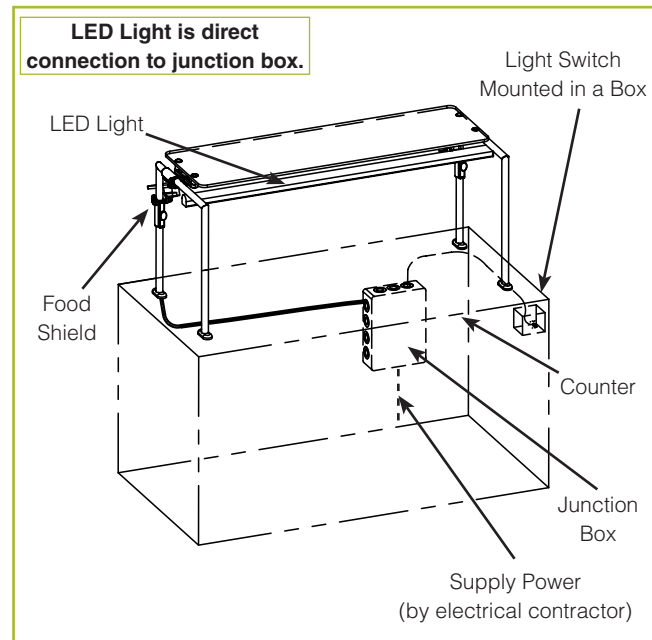

Stealth™ Warmer

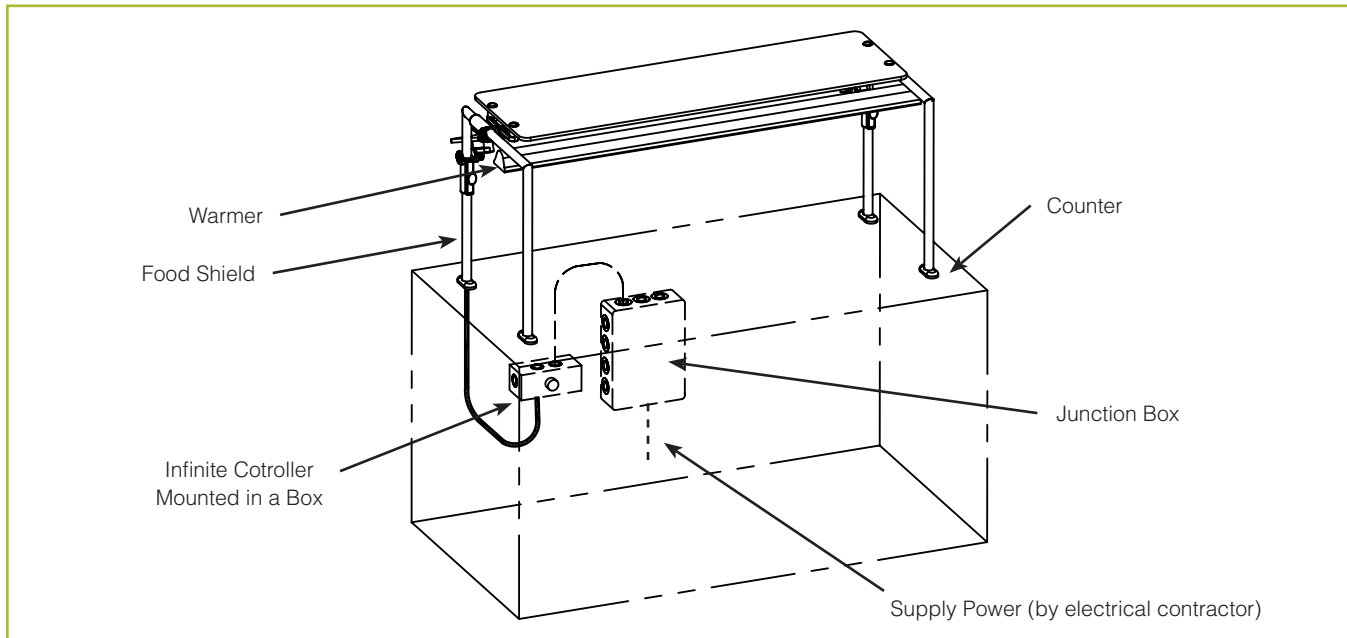

Typical Food Shield Light and Warmer Installations

- All wiring should be performed by a certified technician.
- Wires are routed through wire chase/support legs per approved shop drawings.
- Mount the ballast box, infinite controllers near the wire chase/support leg.
- The ballast box, infinite controllers, light switch and 6 feet of conduit/wiring exiting support legs are all provided with all models of BSI, LLC Food Shields. All other components are provided by others.

WIRING DIAGRAMS

Remote Infinite Control for Stealth™ Warmer/Combo Units

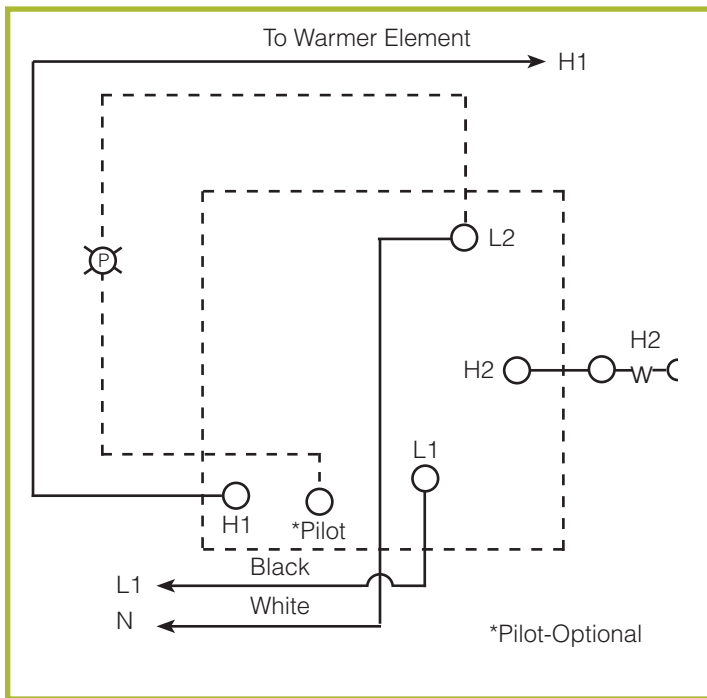

INFINITE SWITCH (120V) - PART #581

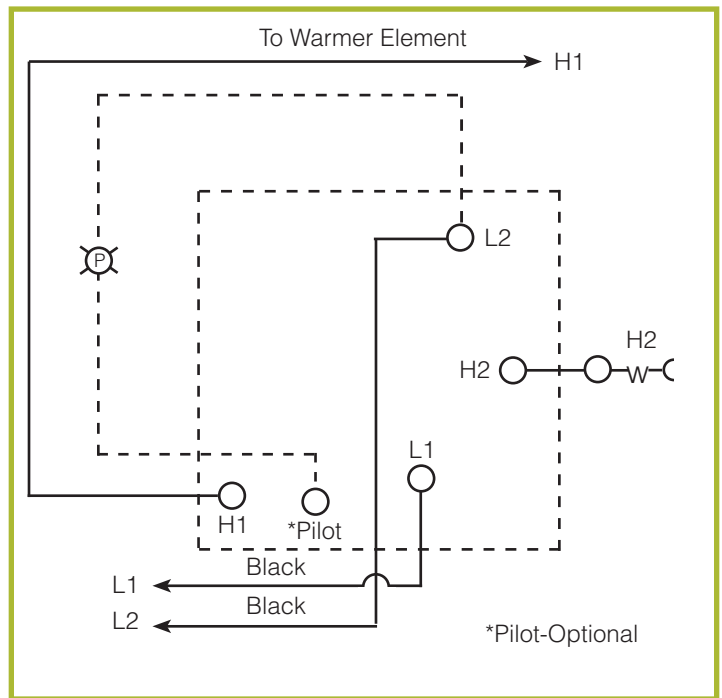

INFINITE SWITCH (208V/240V) - PART #582

FLUORESCENT LIGHT BALLASTS



As a standard, all BSI fluorescent lights are supplied with a remote ballast (internal ballasts are available). This UL Listed ballast is supplied in a UL approved box that needs to be located and installed below the counter.

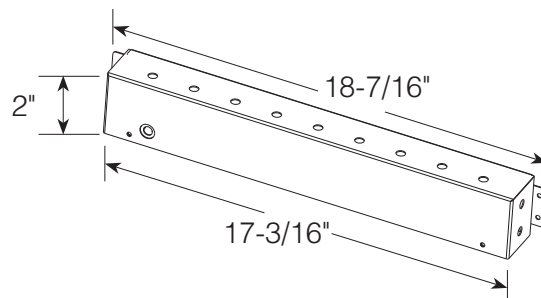

Ballast Box for
 LH1 - Part #509-1 & LH2 - Part #509-2
 LH4 - Part #509-4

DIAGRAMS FOR FLUORESCENT LIGHTS AND LIGHT/WARMER COMBO UNITS

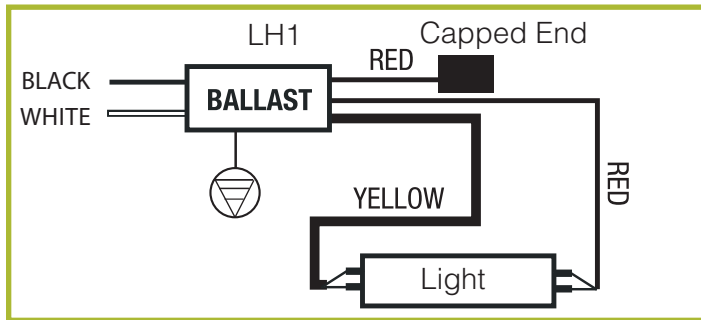

LONGHORSE 1 - LINEAR

On Stealth Heat/Light Combo

Description	Lamp Type
16"-18" T5 Fluorescent Fixture	F6 / T5
19"-27" T5 Fluorescent Fixture	F8 / T5
28"-39" T5 Fluorescent Fixture	F14/T5
40"-51" T5 Fluorescent Fixture	F21/T5
52"-62" T5 Fluorescent Fixture	F28/T5

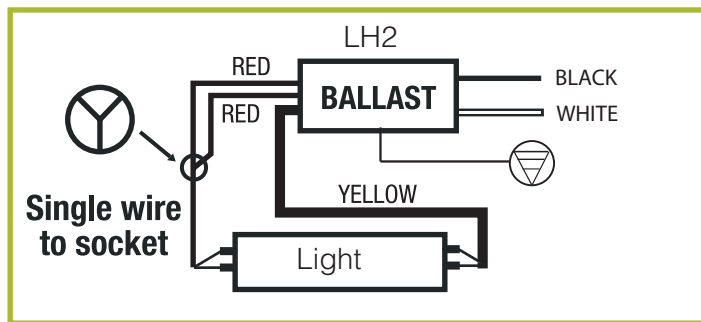

LONGHORSE 2 - LINEAR

On Stealth Heat/Light Combo

Description	Lamp Type
65"-74" T5 Fluorescent Fixture	F35 / T5

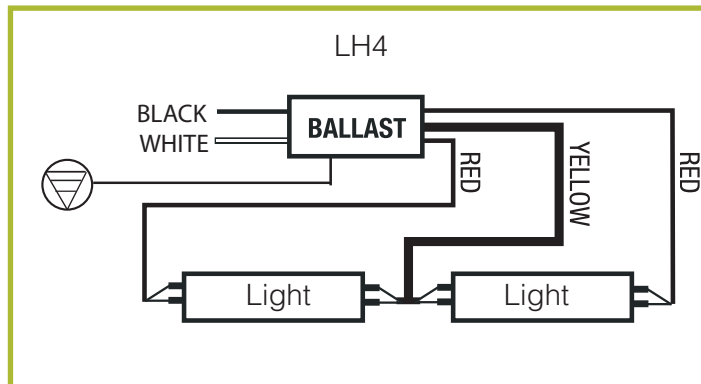

LONGHORSE 2 - LINEAR

On Stealth Heat/Light Combo

Description	Lamp Type
75"-86" T5 Fluorescent Fixture	(2) F21 / T5

This is the LH2 Ballast but is wired like an LH4.

LONGHORSE 4 - LINEAR

On Stealth Heat/Light Combo

Description	Lamp Type
87"-98" T5 Fluorescent Fixture	(1) F21 & (1) F28 / T5
99"-110" T5 Fluorescent Fixture	(2) F28 / T5
111"-121" T5 Fluorescent Fixture	(1) F28 & (1) F35 / T5
122"-144" T5 Fluorescent Fixture	(2) F35 / T5

BSI, LLC WARRANTY

BSI, LLC warrants its products to be free from defects in material and workmanship from the date of their original purchase for normal use and for the applicable warranty periods set forth below. BSI, LLC's warranty extends only to original purchasers acquiring new products purchased in the United States directly from BSI, LLC, its authorized dealers or other companies specifically authorized by BSI, LLC to act as resellers of its products.

XGUARD

BSI, LLC warrants the XGuard system against defects in material and workmanship for a period of two years from invoice date. This excludes glass chipping or breakage after installation that can be explained as "use and abuse".

STEALTH WARMERS

BSI, LLC warrants the Stealth Warmer against defects in material and workmanship for a period of two years from invoice date. The warming element is warranted for two years from invoice date.

FLUORESCENT LIGHT BALLAST

The Slimline Light warranty is for material and workmanship for the period of two years from invoice date. The fluorescent bulb itself is not covered under warranty.

LED LIGHT

The LED Light warranty is for material and workmanship for the period of two years from invoice date. The fluorescent bulb itself is not covered under warranty.

THERE ARE NO WARRANTIES EXCEPT AS EXPRESSLY STATED ABOVE, WHETHER EXPRESSED OR IMPLIED, INCLUDING, BUT NOT LIMITED TO, ANY WARRANTY OF MERCHANTABILITY OR FITNESS FOR ANY PARTICULAR PURPOSE. These warranties do not apply to any products which have been altered in any way or to products which have been subject to misuse, abuse, neglect, accident, or which have been damaged in transit. Warranty is void if products are used, held or stored in an unsupervised environment. BSI, LLC's liability for its products shall be limited to the repair or replacement of products or, at BSI, LLC's option, to refunding the purchase price. BSI, LLC will not be liable, under any circumstances, for incidental or consequential damages (including, without limitation, to lost profits) arising in connection with the sale, use, inability to use, repair or replacement of BSI, LLC's products. The liability of BSI, LLC arising from any cause shall not exceed the price paid for the products.

Any claim for breach of the foregoing warranties shall be deemed waived unless submitted to BSI, LLC in writing within 30 days of the date the alleged defect was discovered, or by reasonable inspection should have been discovered. The merchandise must be returned to the BSI, LLC factory from which it was purchased, freight prepaid, and will not be accepted unless prior written authorization to return the merchandise has been issued by BSI, LLC. A copy of the original invoice must accompany the returned merchandise to prove the date of original purchase and warranty entitlement. Any cause of action for breach of the foregoing warranties shall be deemed waived unless brought within one year of the date of the claim submission.

BSI, LLC

**601 E. 64th Ave., Bldg. A
Denver, CO 80229**

1.800.662.9595
www.BSIdesigns.com

